

# AR593



## Universal transmitter / separator with current and voltage output



- universal thermometric and analog input
- two independent configurable outputs:
  - current 0/4÷20 mA (active output, cannot be supplied in two-wire current loop)
  - voltage 0/2÷10 V
- programmable alarms for exceeded setpoints with hysteresis
- input type, processing range and other processing parameters configured with AR950 or AR956 programmer
- signalling the exceeded processing range, sensor error or alarm output status (on-off type)
- triple galvanic separation(input / output / power)
- high accuracy and immunity to interferences
- housing for mounting on a DIN rail, IP20

### Contents of set:

- transmitter
- user manual
- warranty card

### Accessories:

- programmer AR956
- programmer AR950

The AR956 programmer can be used to power the transmitter from the USB port during configuration.

### How to order AR593

The transmitter can be configured by the manufacturer, the order should specify the type of input, range and other parameters described in the user's manual (available at [www.apar.pl](http://www.apar.pl))  
For example: AR593 / J / 0...20 mA / 100...600 °C

### TECHNICAL DATA

<b>Input</b> (programmable)	<b>Pt100</b> (factory setting), Pt500, Pt1000, Ni100, (2- i 3-wire) J,K,S,B,R,T,E,N(compensation of temperature of the referencejunction) 0/4÷20 mA, 0÷10 V, 0÷60 mV 0÷2,5 kΩ
<b>Processing range</b>	programmable in the input measuring range, factory:0÷500 °C
<b>Output</b> - current	0/4÷20 mA, $R_o \leq 500 \Omega$ , factory setting: 4÷20 mA (active output)
- voltage	0/2÷10 V, $R_w > 2,5 k\Omega$ , factory setting: 0÷10 V
<b>Basic processing error</b>	0,1% of the measurement range
<b>Additional error for thermocouples</b>	<2 °C (cold ends temperature)
<b>Power supply</b>	24 Vac/dc (18÷50 Vdc, 13÷35 Vac), <850 mW
<b>Separation</b>	1,5kV, 50 Hz, 1min
<b>Response time</b> (10÷90%)	360 ms, programmable in range 0,24÷1,6 s
<b>Signaling of alarms and errors</b>	red LED diode, output signals3,8 mA or 21 mA
<b>Rated operating conditions</b>	0÷65 °C, 0÷90 %RH (non-condensing)

### DIMENSIONS AND INSTALLATION DATA

<b>Enclosure dimensions</b>	79x101x17,5 mm
<b>Fixing methods</b>	on a 35 mm DIN rail
<b>Material</b>	polycarbonate, ABS UL94V-0

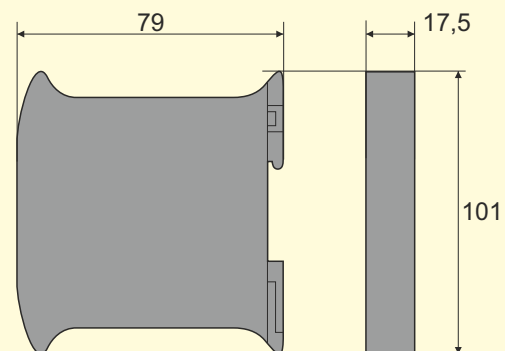

### TERMINAL STRIPS AND ELECTRICAL CONNECTIONS

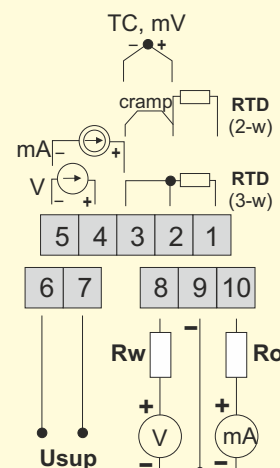

2014.07.07 version 2.0.0